

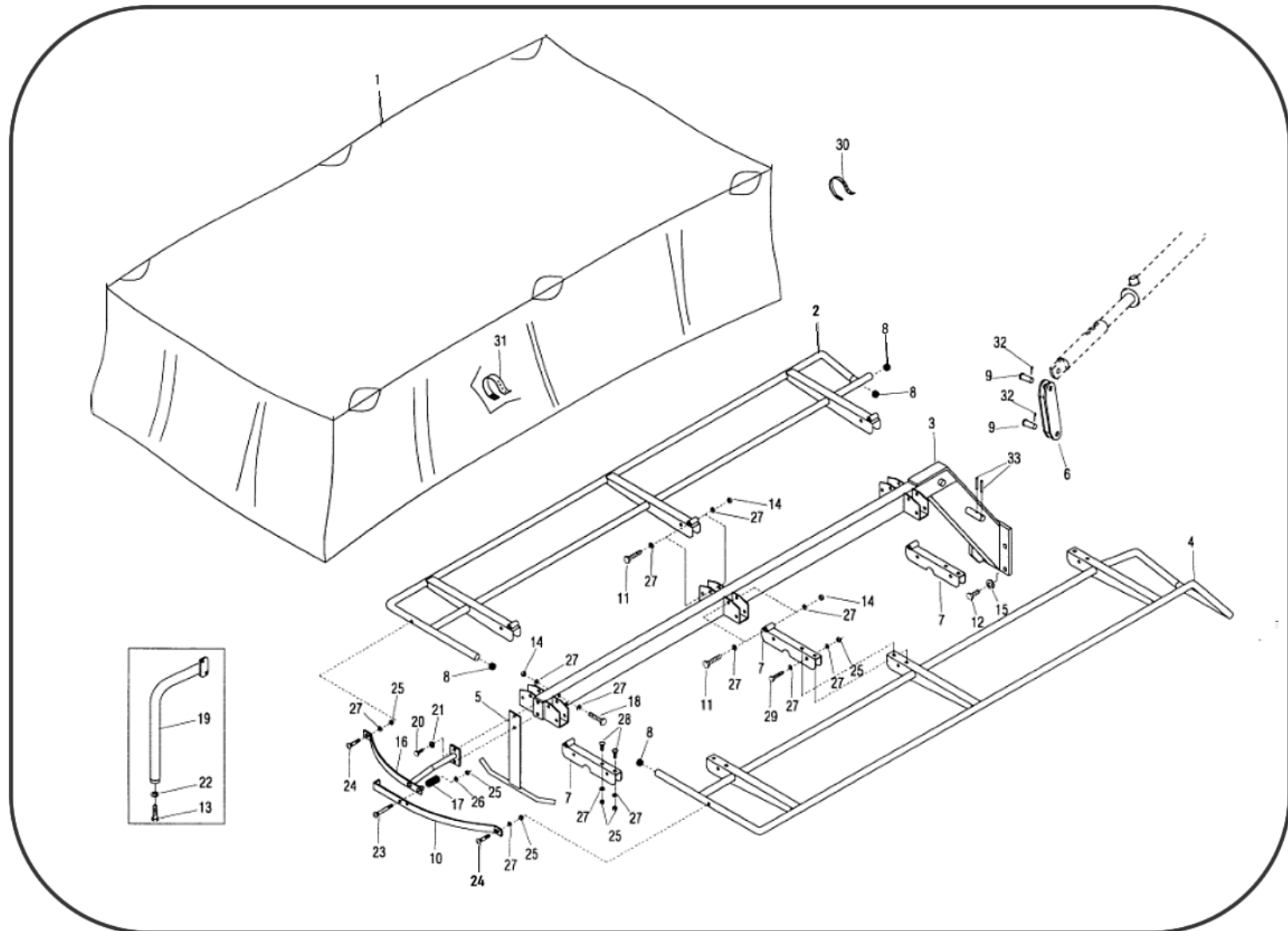

FORT DMD SAFETY GUARD PARTS LIST

carverequipment.com





SAFETY GUARD PARTS LIST

No.	Codice	2040	2050	2060	2070	Part Description	No.	Codice	2040	2050	2060	2070	Part Description
01	018191	1	-	-	-	STURDY CANVAS	11	854179	4	6	6	6	SCREW TE M10x65 ZN -5737
01	018192	-	1	-	-	STURDY CANVAS	12	850804	4	4	4	4	SCREW TE M16x40 ZN -5739
01	018193	-	-	1	-	STURDY CANVAS	13	854137	*	1	1	1	SCREW TE M14x50 UNI 5739 ZN
01	018194	-	-	-	1	STURDY CANVAS	14	851118	4	8	8	8	SELF LOCKING NUT. M10 LOW
02	018158	1	-	-	-	REAR PROTECTION	15	850905	4	4	4	4	GROWER WASHER Ø 16 ZN
02	018161	-	1	-	-	REAR PROTECTION	16	018187	1	1	1	1	FIXED OUTER SHIELD
02	018164	-	-	1	-	REAR PROTECTION	17	018188	1	1	1	1	SPRING
02	018167	-	-	-	1	REAR PROTECTION	18	850823	*	2	2	2	SCREW TE M10x70 ZN -5737
03	014852	1	-	-	-	PROTECT. HOLDER FRAME	19	018145	*	1	1	1	REINFORCED EXTENSION
03	014853	-	1	-	-	PROTECT. HOLDER FRAME	20	850936	2	2	2	2	SCREW M10X30 ZN -5739
03	014854	-	-	1	-	PROTECT. HOLDER FRAME	21	850902	2	2	2	2	GROWER WASHER Ø 10 ZN
03	014855	-	-	-	1	PROTECT. HOLDER FRAME	22	850904	*	1	1	1	GROWER WASHER Ø 14 ZN
04	018170	1	-	-	-	FRONT PROTECTION	23	850615	1	1	1	1	SCREW TTQST M10x80 -ZN -5731
04	018173	-	1	-	-	FRONT PROTECTION	24	850616	2	2	2	2	SCREW TTQST M10x50 -ZN -5731
04	018176	-	-	1	-	FRONT PROTECTION	25	851103	9	12	12	12	SELF LOCKING NUT. M10
04	018179	-	-	-	1	FRONT PROTECTION	26	854038	1	1	1	1	FLAT WASHER Ø 11-23-2.5 ZN
05	018139	1	1	1	1	CANVAS GUIDE BRACKET	27	850913	16	26	26	26	FLAT WASHER Ø 10 ZN -6592
06	009395	1	1	1	1	LIFTING ROD	28	850605	4	6	6	6	SCREW TTQST M10x25 -ZN -5731
07	018155	2	3	3	3	SHIELD EXTENSION	29	850996	2	3	3	3	SCREW TE M10x60 UNI 5737 ZN
08	853216	4	4	4	4	PLASTIC CAP	30	014976	6	6	6	8	CLAMP
09	009478	2	2	2	2	CUTTERBAR LIFTING PIN	31	009477	2	2	3	3	CLAMP
10	018182	1	1	1	1	MOBILE OUTER SHIELD	32	852331	2	2	2	2	SPLIT PIN Ø 4x35
							33	852134	2	2	2	2	FLEXIBLE PIN Ø 8x50

Find the part(s) you need. Write down the Model Number, Part Number and how many you want.

Go back to our website and find the "contact" order form [<https://www.carverequipment.com/mobi/contact.html>]

OR call Steve: **919-902-0522** to place your parts order.